



roma

The logo features the word "roma" in a bold, lowercase, sans-serif font. The letter "o" is stylized with a series of horizontal lines that create a sense of motion or a globe. The background is a solid purple color with several curved, light purple lines on the left side that sweep across the frame.

we move everything



roma

we move everything

This young company is built on the experience of a team of entrepreneurs who have been working in the handling industry for over 15 years. They are committed to developing concepts for the most diverse segments of industry, spanning from pharmaceuticals, through food, to mechanical components, with-out any limit in terms of product and design.

Roma stands out for its pro-active approach to business which aims at meeting customer requirements while ensuring reliability and expertise. Every solution is the result of the synergy created between customers and our design and development teams, with an eye always set on innovation. Our staff is constantly updated and trained to offer utmost professionalism throughout the entire production process.

Ideas, projects and products... **We move everything!**



INDEX

king conveyor.....5
 robot protection6
 photocells7
 king overedges8
 king motorization9
 genius control panel 10
 rook conveyor 11
 quick line 12
 knight conveyor 14
 bishop conveyor 15
 check conveyor 16
 mate conveyor 17
 plastic belt 18
 metal belt 20
 z-shaped conveyor 22
 white separator 23
 black separator 24
 castle stair elevator 26
 o-round storage system 28
 spoon dispenser 29
 blend mixer 30
 big blend 31
 dolly carousel.....32

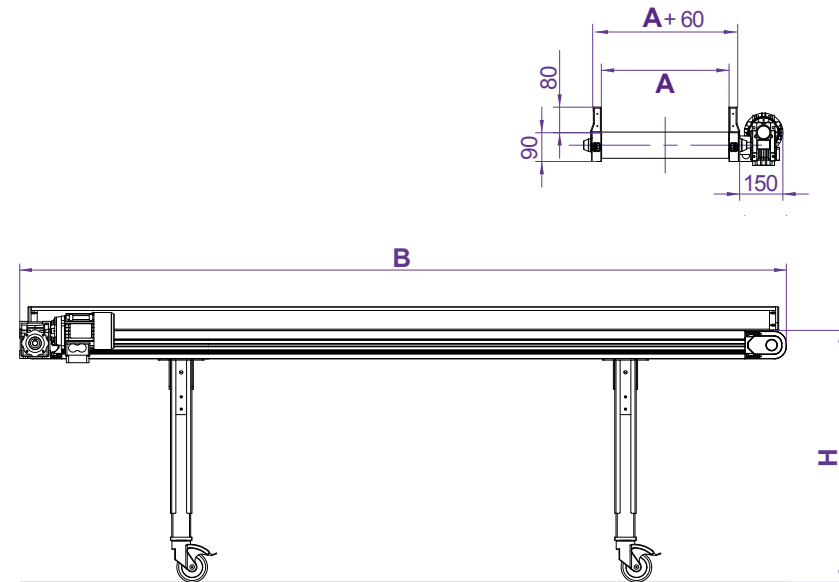

CHARACTERISTICS

- Standard flat conveyor
- Suitable for conveying lines, assembly lines and to work under IMM or with robot

TECHNICAL SPECIFICATIONS

- Structure made of aluminium anodised profile height 90 mm
- With side panels height 80 mm
- Without possibility to work inclined
- Smooth PU belt, without slats, vulcanised belt joint. Temperature resistance from -10°C to + 90°C
- Transmission group composed of: three-phase motor, coupled to worm reduction unit with lubrication for life
- Fixed standard speed ~4 m/min
- Equipped with Start/Stop motor cut-out
- Standard motor supply voltage 400V/50 Hz

KING DIMENSIONS

DIMENSION	min (mm)	max (mm)
A	100	1200
B	600	6000
H	200	2000

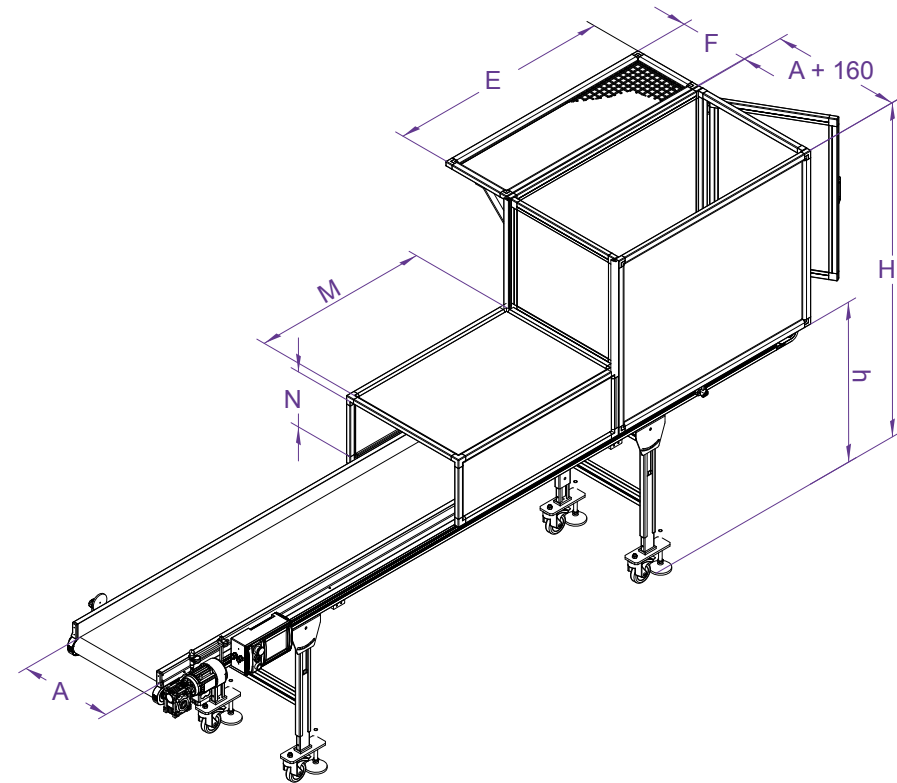

Rear door with safety micro



Lateral protective roof

CHARACTERISTICS

- Robot protection composed of a stout aluminium frame complete with polycarbonate or metallic net cover
- Robot protection complete with a rear door opening, useful to check products samples
- Robot protection complete with a lateral protective roof

TECHNICAL FEATURES

- All protections are built according to specific requirements from the customer
- Rear door protected by a safety micro allowing the descent of the robot only when perfectly closed (its connection to the robot at customer charge)

HOW TO CHOOSE A PHOTOCELL

- Ft standard: when positioned inside the containment edges it is considered our standard solution
- Ft laser: this photocell replaces the standard one when the product to convey is less than 20 mm height
NB: this photocell detects products with minimum height of 0,9 mm at 1 mt depth, and products with minimum height of 2 mm at 3 mt depth
- Ft for transparency: some in-house test are highly recommended before choosing this ft model

Photocell distance from control panel:

- From 0 to 5 mt the wire is provided already connected to the photocell
- From 5 to 15 mt a 3x1mm wire needs to be prepared for connection (the photocell will have a non-wired connector)



MODELS	
MODEL	
FT STANDARD	Depth of field: from 0,1 to 3 mt Min. height of the product = 20 mm
FT LASER	Depth of field: from 0,1 to 3 mt Min. height of the product: - from 0,9 mm to 1 mt - from 2 mm to 3 mt
FT FOR TRANSPARENCY	Depth of field: from 0 to 2 mt Detects: glass, Polycarbonate, nylon, PET bottles
Mod. BOS 21M-PA-PT10-S4	Depth of field: from 0 to 2 mt Beam: Ø 10 mm at 1 mt depth

CONFIGURATIONS

PHOTOCELL INSIDE THE CONTAINMENT EDGES

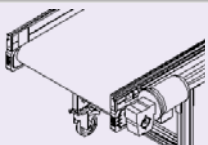

FIXED PHOTOCELL AT CONVEYOR'S END

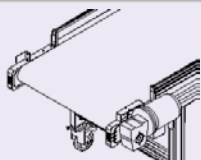

PHOTOCELL WITH ADJUSTABLE HEIGHT

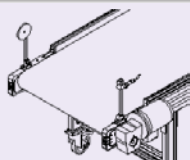

EXTERNAL PHOTOCELL WITH ADJUSTABLE HEIGHT

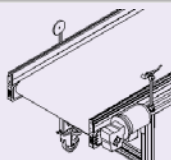

overedges 150

CHARACTERISTICS

- Overedges made of stainless steel AISI 304 h 150 mm
- To convey products with large size or quantity

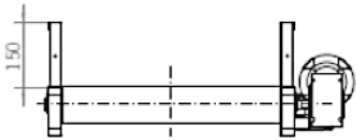

overedges 80 SS

CHARACTERISTICS

- Overedges made of stainless steel AISI 304 h 80 mm complete with additional side protections
- Solution to be proposed when products must not come into contact with non-FDA surfaces or to avoid small pieces getting stuck between the side panels and the profile

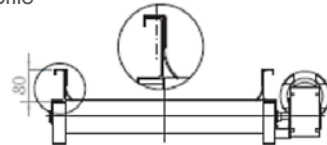

overedges 40 W

CHARACTERISTICS

- Adjustable in width
- To convey products (e.g. boxes) with large size

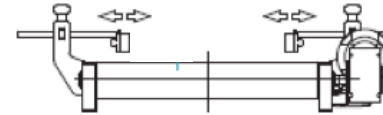

overedges 40 WH

CHARACTERISTICS

- Overedges adjustable both in width and height
- To convey products (e.g. boxes) with large size



legs adjustable in inclination

CHARACTERISTICS

- Legs adjustable in inclination from min 0° to max 30°

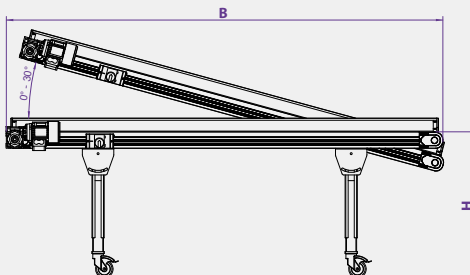

feet and wheels

CHARACTERISTICS

- Stabilizer feet to avoid vibrations
- Particularly recommended with robot applications

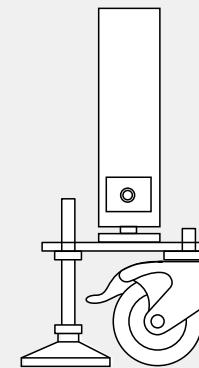

with standard drive unit or drive unit under conveyor

with drum motor

STANDARD DRIVE ROLLER OR DRIVE ROLLER UNDER CONVEYOR DIAM. 76		
RATIO MOTOR	MOTOR POWER KW	SPEED MT/M
1:80	0,12 KW	4,5 mt/m
1:60	0,12 KW	6 mt/m
1:50	0,12 KW	7 mt/m
1:40	0,18 KW	9 mt/m
1:30	0,18 KW	12 mt/m
1:25	0,18 KW	14,5 mt/m
1:20	0,25 KW	18 mt/m
1:15	0,25 KW	24 mt/m
1:10	0,37 KW	36 mt/m

DRUM MOTOR ROLLER DIAM. 80	
RATIO GEARBOX	WIDTH
Ø 80 mm - 0,04 KW - 3,5 mt/m	width min 300 mm
Ø 80 mm - 0,08 KW - 6 mt/m	width min 300 mm
Ø 80 mm - 0,14 KW - 8,5 mt/m	width min 300 mm
Ø 80 mm - 0,14 KW - 11,5 mt/m	width min 300 mm
Ø 80 mm - 0,14 KW - 13 mt/m	width min 300 mm
Ø 80 mm - 0,14 KW - 17 mt/m	width min 300 mm
Ø 80 mm - 0,14 KW - 18,5 mt/m	width min 300 mm
Ø 80 mm - 0,14 KW - 26,5 mt/m	width min 300 mm

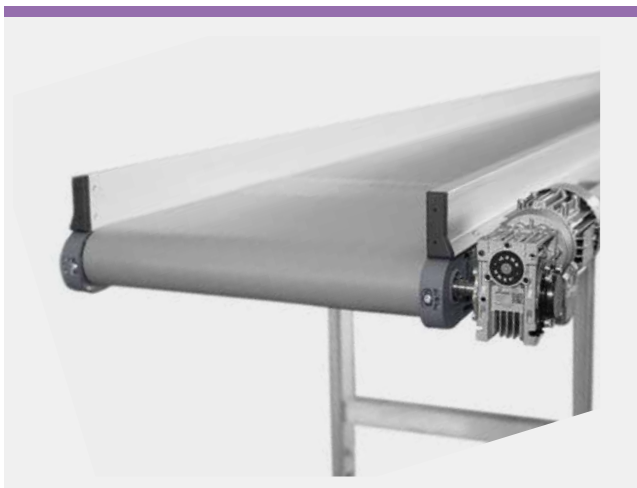

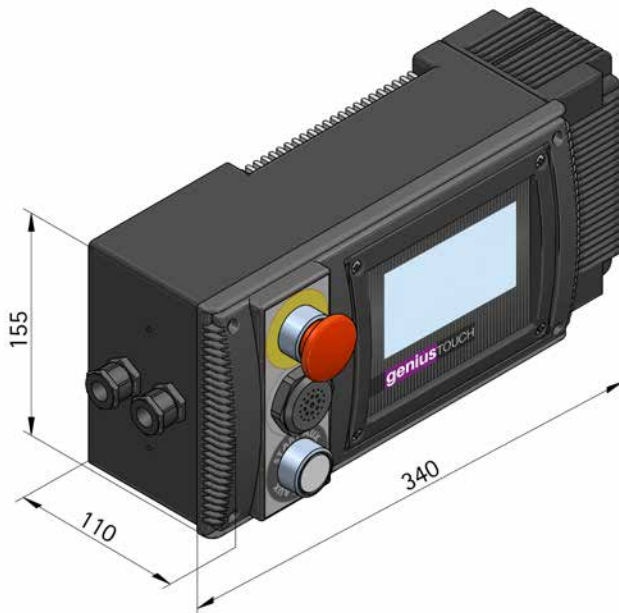

CHARACTERISTICS

- The Genius Control Panel offers multiple and specifically programmable functions (see data sheet)

TECHNICAL FEATURES

- Maximum power: 0.75 kW
- Rating: IP 54

GENIUS CONTROL PANEL

GENIUS CONTROL PANEL	
PROGRAM	
MANUAL	For manual operation
PAUSE-WORK	Sets work and pause timing in hours, minutes and seconds.
PULSE	For pulse operation
FEEDER	Starts up the conveyor for a time equal to the duration of the signal coming from the robot. At the end of the feed signal, the control panel stops the conveyor and waits for the next signal.

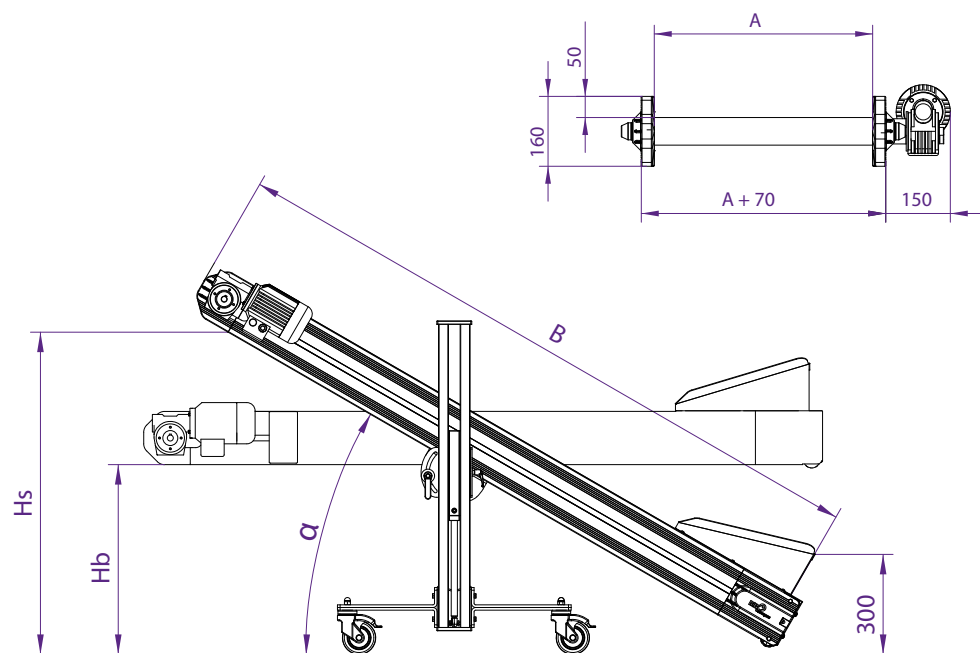

CHARACTERISTICS

- Conveyor adjustable in inclination
- Suited to collect products and convey them at an adjustable height, thanks to its central support

TECHNICAL FEATURES

- Structure made of aluminium anodised profile height 160 mm
- With side panel not removable height 50 mm
- Smooth PU belt, slats h 30 mm pitch 400 mm, vulcanised belt joint. Temperature resistance from -10°C to + 90°C
- Transmission group composed of: three-phase motor, worm reduction unit with lubrication for life
- Fixed standard speed ~3 m/min
- Equipped with Start/Stop motor cut-out
- Standard motor supply voltage 400V/50 Hz

ROOK DIMENSIONS

MODEL	A (mm)	B (mm)	α	Hs (mm)
ROOK 3/15	340	1500	45°	900
ROOK 3/20	340	2000	40°	1100
ROOK 3/25	340	2500	35°	1250
ROOK 4/15	440	1500	45°	900
ROOK 4/20	440	2000	40°	1100
ROOK 4/25	440	2500	35°	1250
ROOK 5/20	540	2000	40°	1100
ROOK 5/25	540	2500	35°	1250
ROOK 5/30	540	3000	30°	1350



The Quick Line series was conceived to respond to two main issues raised by the market:

- necessity of compact, easy-fitting conveyors, suitable for different uses and especially where limited space is a crucial element (e.g. under IMM)
- reduction of transport costs, which sometimes can considerably impact on the final price

THE NEW QUICK LINE SERIES INCLUDES COMPACT CONVEYORS WHICH CAN BE INSTALLED IN LIMITED SPACES, WITH A SPECIAL PACKING SOLUTION TO ALLOW FLEXIBLE USE AND A CONSIDERABLE REDUCTION IN TRANSPORT COST.



The special removable housings allow to flatten the conveyors with change of direction.



Considerable reduction of volume, leading to significant cuts in packing and transport cost.

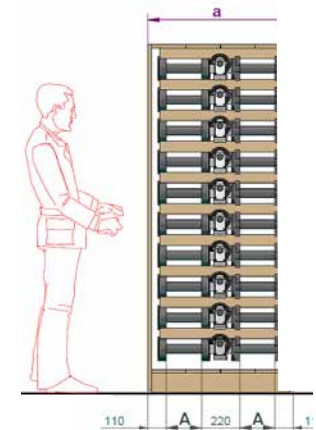

CONSIDERABLE TRANSPORT COST REDUCTION

PACKAGING OPTIONS				
	NUMBER OF CONVEYOR	A	B	H
KNIGHT	up to 7 (single row)	$A + 345$	$C + B + 200$	no. of conveyors (max 7) x 180 + 400
	from 8 to 20 (double row)	$2 \times A + 440$	$C + B + 200$	no. of conveyors (max 10) x 180 + 400
BISHOP	up to 7 (single row)	$A + 345$	$C + B + D + 200$	no. of conveyors (max 7) x 180 + 400
	from 8 to 20 (double row)	$2 \times A + 440$	$C + B + D + 200$	no. of conveyors (max 10) x 180 + 400



**WE CAN SHIP UP TO
7 CONVEYORS OVERLAPPED
ON A SINGLE ROW!**

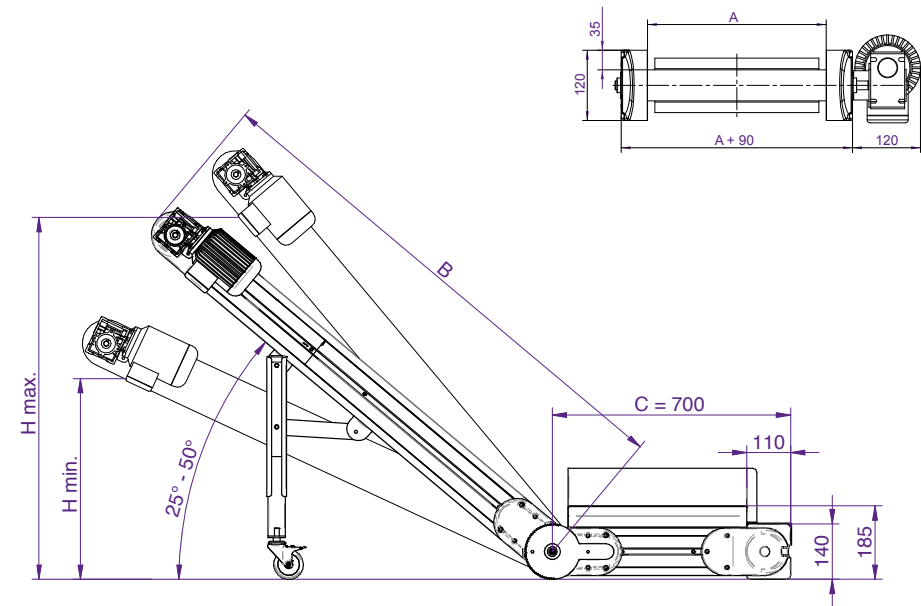

CHARACTERISTICS

- Necessity of compact, easy-fitting conveyors, suitable for different uses and especially where limited space is a crucial element (e.g. under IMM)
- Adjustable angle from min 25° to max 50°
- Options: unloading chute / loading hopper

TECHNICAL FEATURES

- Structure made of aluminium anodised profile height 120 mm
- With side panel not removable height 35 mm
- Smooth PU belt, slats h 30 mm pitch 400 mm, vulcanised belt joint. Temperature resistance from -10°C to + 90°C
- Transmission group composed of: three-phase motor, worm reduction unit with lubrication for life
- Fixed standard speed ~3 m/min
- Equipped with Start/Stop motor cut-out
- Standard motor supply voltage 400V/50 Hz

KNIGHT DIMENSIONS

DIMENSION	A (mm)	B (mm)	H 25° (mm)	H 50° (mm)
KNIGHT.0	155	1500	500	1050
KNIGHT.1	255	1500	500	1050
KNIGHT.2	355	1800	650	1250

➔ The sum of the horizontal section (C) and the inclined section (B) shall not exceed 3000 mm

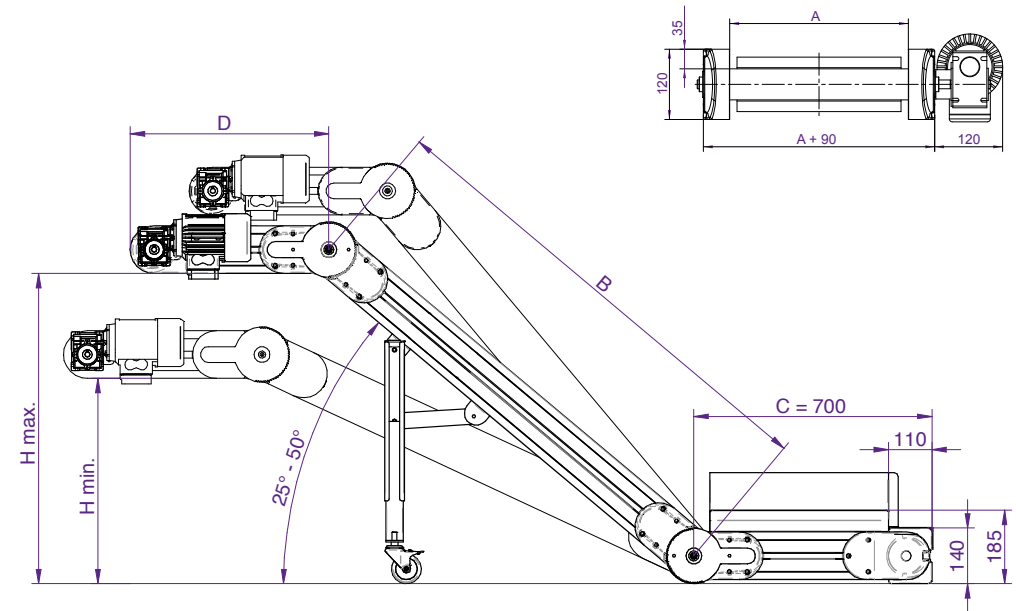

CHARACTERISTICS

- Necessity of compact, easy-fitting conveyors, suitable for different uses and especially where limited space is a crucial element (e.g. under IMM)
- Adjustable angle from min 25° to max 50°
- Options: unloading chute / loading hopper

TECHNICAL FEATURES

- Structure made of aluminium anodised profile height 120 mm
- With side panel not removable height 35 mm
- Smooth PU belt, slats h 30 mm pitch 400 mm, vulcanised belt joint. Temperature resistance from -10°C to + 90°C
- Transmission group composed of: three-phase motor, worm reduction unit with lubrication for life
- Fixed standard speed ~3 m/min
- Equipped with Start/Stop motor cut-out
- Standard motor supply voltage 400V/50 Hz

BISHOP DIMENSIONS

DIMENSION	A (mm)	B (mm)	H 25° (mm)	H 50° (mm)
BISHOP.0	155	1500	550	1100
BISHOP.1	255	1500	550	1100
BISHOP.2	355	1800	700	1500

➔ The sum of the horizontal lower section (C), the inclined section (B) and the horizontal upper section (D) shall not exceed 3000 mm

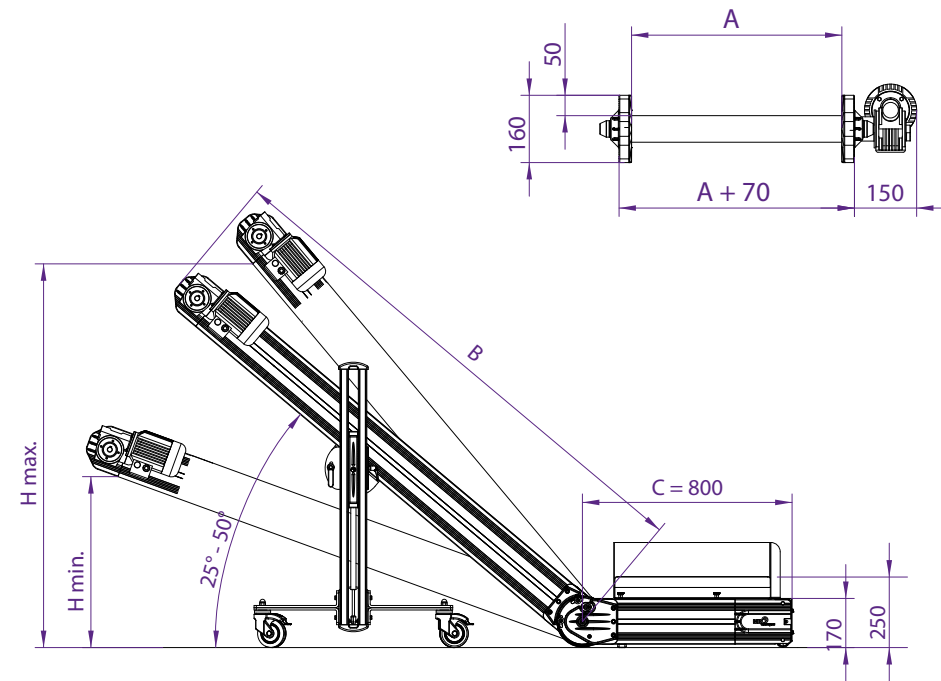
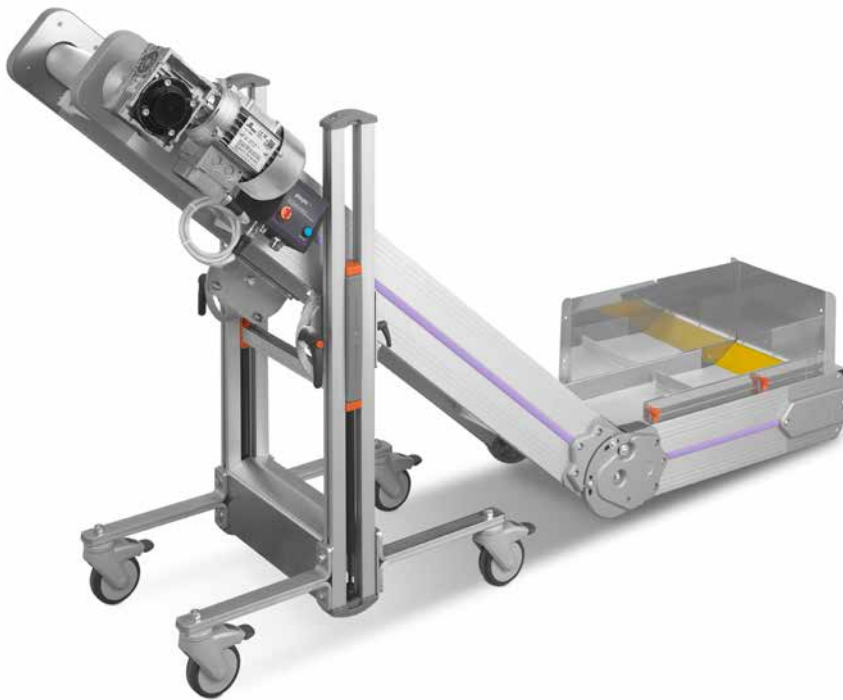

CHARACTERISTICS

- Suitable for different uses and applications especially to be combined with IMM
- Adjustable angle from min 25° to max 50°
- Options: unloading chute / loading hopper

TECHNICAL FEATURES

- Structure made of aluminium anodised profile height 160 mm
- With side panel not removable height 50 mm
- Smooth PU belt, slats h 30 mm pitch 400 mm, vulcanised belt joint. Temperature resistance from -10°C to + 90°C
- Transmission group composed of: three-phase motor, worm reduction unit with lubrication for life
- Fixed standard speed ~3 m/min
- Equipped with Start/Stop motor cut-out
- Standard motor supply voltage 400V/50 Hz

CHECK DIMENSIONS

DIMENSION	A (mm)	B (mm)	H 25° (mm)	H 50° (mm)
CHECK.0	140	1500	550	1000
CHECK.1	240	1500	550	1000
CHECK.2	340	1800	650	1250
CHECK.3	440	2000	750	1400
CHECK.4	540	2000	750	1400

➔ The sum of the horizontal lower section (C) and the inclined section (B) shall not exceed 6000 mm

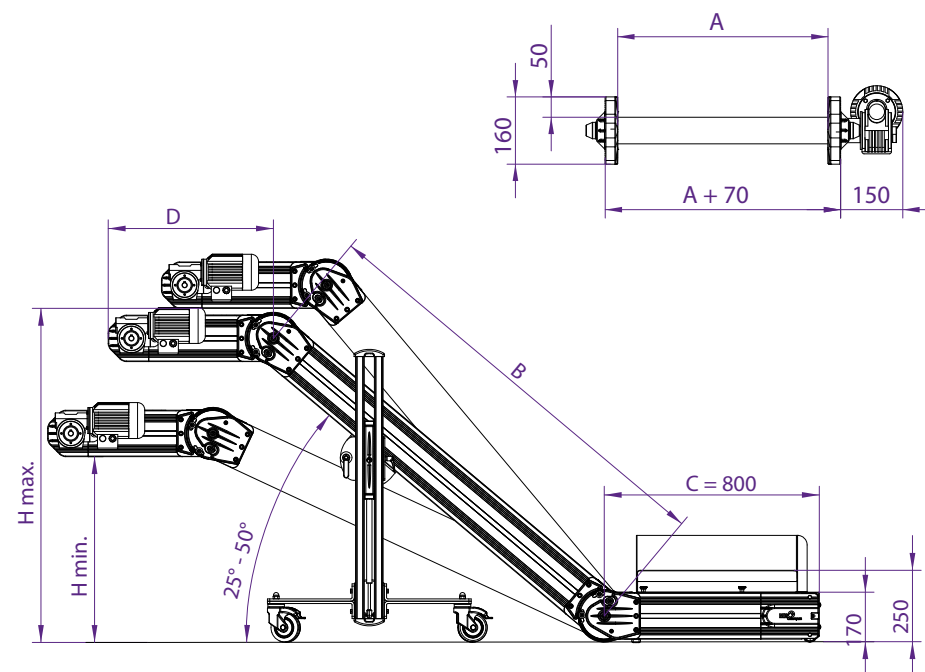

CHARACTERISTICS

- Suitable for different uses and applications especially to be combined with IMM
- Adjustable angle from min 25° to max 50°
- Options: unloading chute / loading hopper

TECHNICAL FEATURES

- Structure made of aluminium anodised profile height 160 mm
- With side panel not removable height 50 mm
- Smooth PU belt, slats h 30 mm pitch 400 mm, vulcanised belt joint. Temperature resistance from -10°C to + 90°C
- Transmission group composed of: three-phase motor, worm reduction unit with lubrication for life
- Fixed standard speed ~3 m/min
- Equipped with Start/Stop motor cut-out
- Standard motor supply voltage 400V/50 Hz

MATE DIMENSIONS

DIMENSION	A (mm)	B (mm)	H 25° (mm)	H 50° (mm)
MATE.0	140	1500	600	1100
MATE.1	240	1500	600	1100
MATE.2	340	1800	700	1350
MATE.3	440	2000	800	1500
MATE.4	540	2000	800	1500

➔ The sum of the horizontal lower section (C), the inclined section (B) and the horizontal upper section (D) shall not exceed 6000 mm

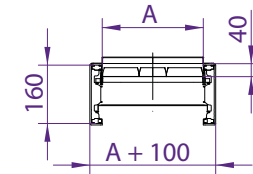

CHARACTERISTICS

- To use with very hot pieces (up to 130°C) or with very small ones
- Recommended with slight presence of lubricants or electrostatic charges

TECHNICAL FEATURES

- Structure made of aluminium anodised profile height 160 mm
- With side panel not removable height 40 mm
- White plastic belt, without slats. Plastic belt complete with special double containment edges, which do not open even during the rotation of the belt itself
- Transmission group composed of: three-phase motor, worm reduction unit with lubrication for life and safety limiter
- Fixed standard speed ~4 m/min
- Equipped with Start/Stop motor cut-out
- Standard motor supply voltage 400V/50 Hz

PLASTIC BELT DIMENSIONS

FLAT.PB	min (mm)	max (mm)
A	175	775
B	1000	5000
H	300	2000



When to choose a plastic belt conveyor?

- With presence of electrostatic charges
- With small quantities of lubricants
- With products to convey which are sharp or very small
- With very hot products (up to 130°C)
- With FDA environments: when it is necessary to periodically disassemble the conveyor and wash the belt, and/or to replace only some parts of the belt
- With cooling applications

on L-shaped conveyor

on Z-shaped conveyor

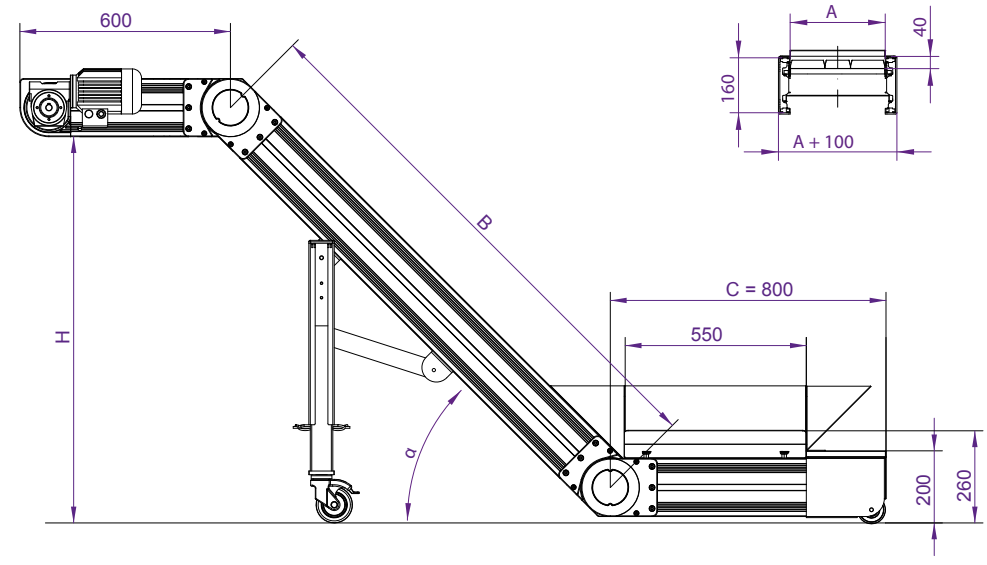
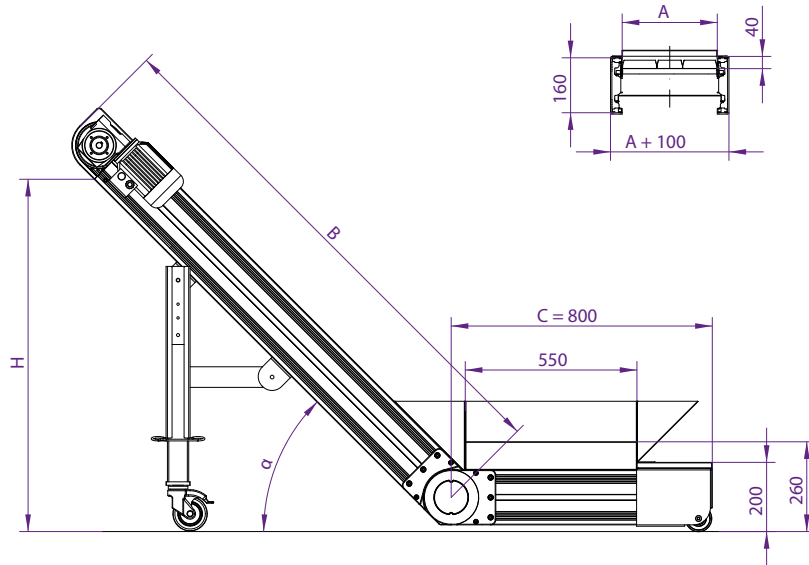

CHARACTERISTICS

- To use with very hot pieces (up to 130°C) or with very small ones
- Recommended with slight presence of lubricants or electrostatic charges
- Options: unloading chute / loading hopper

TECHNICAL FEATURES

- Structure made of aluminium anodised profile height 160 mm
- With side panel not removable height 40 mm
- White plastic belt, with slats h 35 mm pitch 400 mm. Plastic belt complete with special double containment edges, which do not open even during the rotation of the belt itself
- Transmission group composed of: three-phase motor, worm reduction unit with lubrication for life and safety limiter
 - Fixed standard speed ~4 m/min
- Equipped with Start/Stop motor cut-out
 - Standard motor supply voltage 400V/50 Hz

L - PLASTIC BELT DIMENSIONS

DIMENSION	A (mm)	B (mm)	H min (mm)	H max (mm)	POSSIBLE α
L.PB0	175	1500	650	1150	30°/40°/50°/60°
L.PB1	275	1500	650	1150	30°/40°/50°/60°
L.PB2	375	1800	800	1400	30°/40°/50°/60°
L.PB3	475	2000	900	1550	30°/40°/50°/60°
L.PB4	575	2000	900	1550	30°/40°/50°/60°

Z - PLASTIC BELT DIMENSIONS

DIMENSION	A (mm)	B (mm)	H min (mm)	H max (mm)	POSSIBLE α
Z.PB0	175	1500	700	1250	30°/40°/50°/60°
Z.PB1	275	1500	700	1250	30°/40°/50°/60°
Z.PB2	375	1800	850	1500	30°/40°/50°/60°
Z.PB3	475	2000	950	1700	30°/40°/50°/60°
Z.PB4	575	2000	950	1700	30°/40°/50°/60°

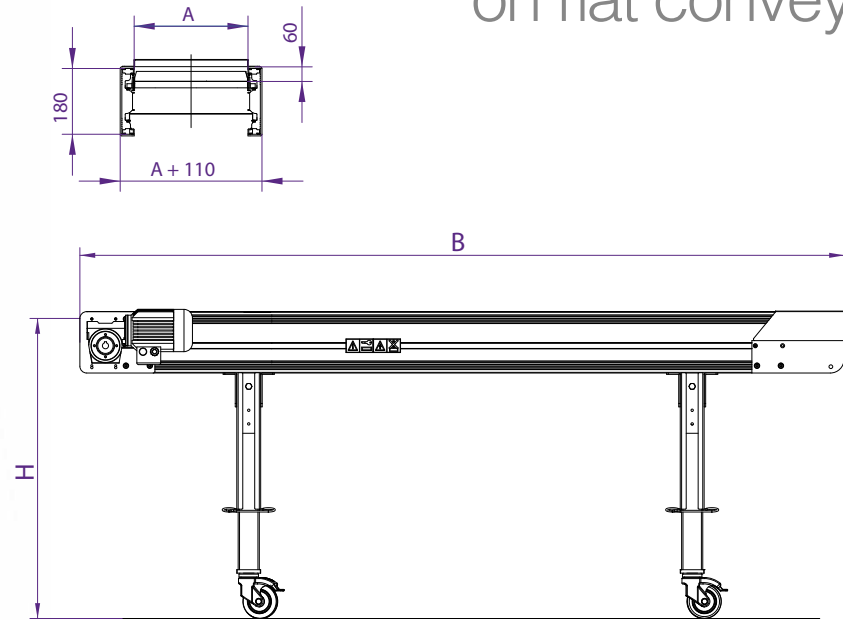

CHARACTERISTICS

- To use with very hot pieces (up to 200°C)
- Recommended for the transport of metallic and sharp pieces, with high presence of lubricants

TECHNICAL FEATURES

- Structure made of aluminium anodised profile height 180 mm
- With side panel not removable height 60 mm
- Metal belt, without slats. Metal belt complete with special double containment edges, which do not open even during the rotation of the belt itself
- Transmission group composed of: three-phase motor, worm reduction unit with lubrication for life and safety limiter
- Fixed standard speed ~4 m/min
- Equipped with Start/Stop motor cut-out
- Standard motor supply voltage 400V/50 Hz

METAL BELT DIMENSIONS

FLAT.MB	min (mm)	max (mm)
A	150	750
B	1000	5000
H	300	2000

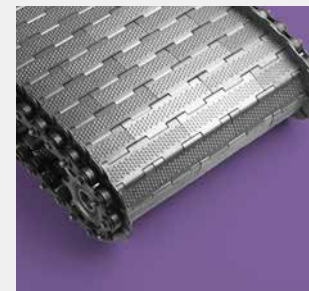
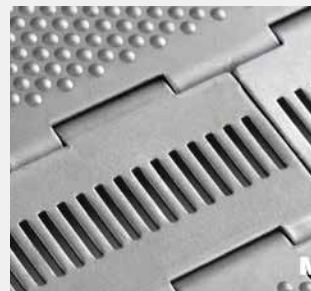

When to choose a metal belt conveyor?

- With very high temperatures (up to +200°C)
- With small / sharp pieces (e.g. screws)
- With high presence of lubricants

on L-shaped conveyor

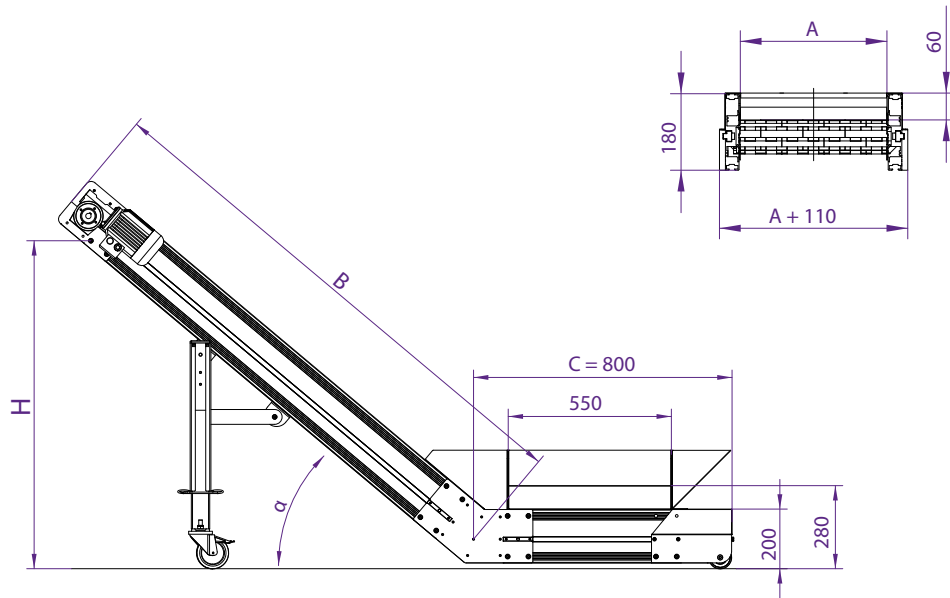

on Z-shaped conveyor

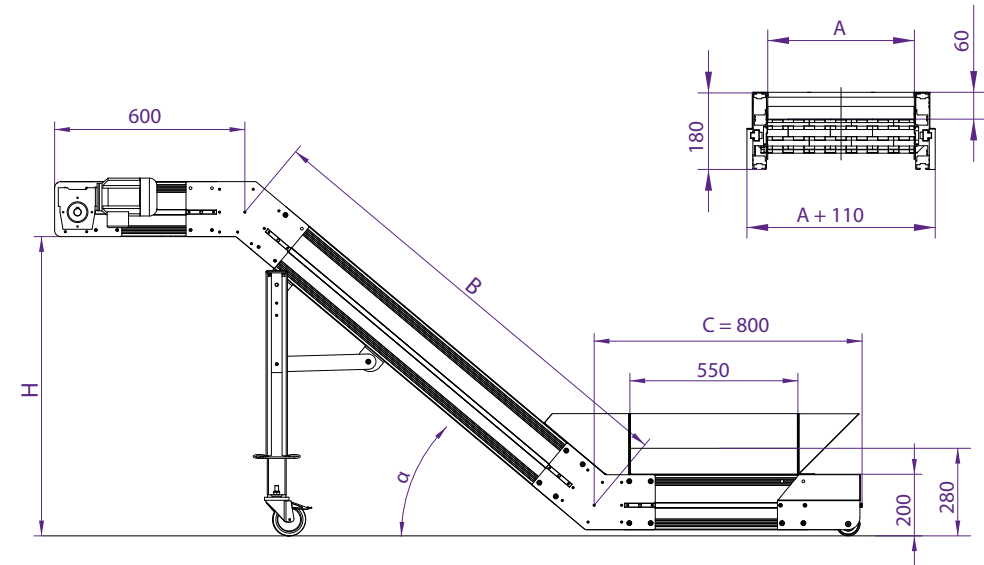

CHARACTERISTICS

- To use with very hot pieces (up to 200°C)
- Recommended for the transport of metallic and sharp pieces, with high presence of lubricants
- Options: unloading chute / loading hopper

TECHNICAL FEATURES

- Structure made of aluminium anodised profile height 180 mm
- With side panel not removable height 60 mm
- Metal belt, with slats h 35 mm pitch 400 mm. Metal belt complete with special double containment edges, which do not open even during the rotation of the belt itself
- Transmission group composed of: three-phase motor, worm reduction unit with lubrication for life and safety limiter
 - Fixed standard speed ~4 m/min
- Equipped with Start/Stop motor cut-out
 - Standard motor supply voltage 400V/50 Hz

L - METAL BELT DIMENSIONS

DIMENSION	A (mm)	B (mm)	H min (mm)	H max (mm)	POSSIBLE α
L.MB0	150	1500	650	1150	30°/40°/50°/60°
L.MB1	250	1500	650	1150	30°/40°/50°/60°
L.MB2	350	1800	800	1400	30°/40°/50°/60°
L.MB3	450	2000	900	1550	30°/40°/50°/60°
L.MB4	550	2000	900	1550	30°/40°/50°/60°

Z - METAL BELT DIMENSIONS

DIMENSION	A (mm)	B (mm)	H min (mm)	H max (mm)	POSSIBLE α
Z.MB0	150	1500	700	1250	30°/40°/50°/60°
Z.MB1	250	1500	700	1250	30°/40°/50°/60°
Z.MB2	350	1800	850	1500	30°/40°/50°/60°
Z.MB3	450	2000	950	1700	30°/40°/50°/60°
Z.MB4	550	2000	950	1700	30°/40°/50°/60°

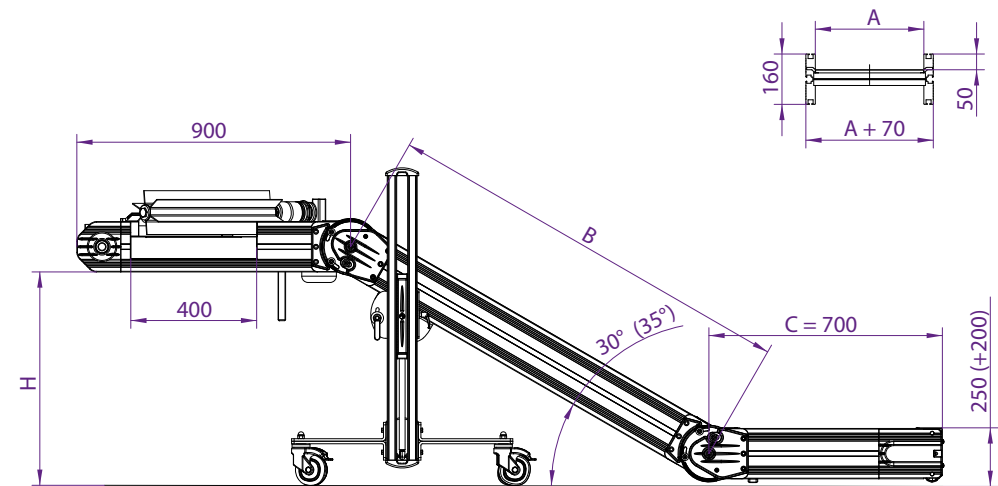

CHARACTERISTICS

- The distance between conveyor belt and paddle separator can be adjusted according to the difference in dimensions and shape between sprues and good parts
- Optional: unloading chute, loading hopper

TECHNICAL FEATURES

- Structure made of aluminium anodized profile height 160 mm
- With side panel not removable h 50 mm
- PVC high grip belt without slats, vulcanised belt joint.
Temperature resistance -10°C to +60°C
- Upper flat part equipped with paddle separator model WP complete of a lateral unloading chute
- Conveyor's transmission group composed of: three-phase asynchronous motor, worm reduction unit with lubrication for life
- Paddle separator's transmission group composed of: three-phase asynchronous motor, worm reduction unit and torque limiter
- Fixed standard speed ~3 m/min
- Equipped with Start/Stop motor cut-out
- Standard motor supply voltage 400V/50 Hz

Z-SHAPED CONVEYOR WITH WHITE WP DIMENSIONS

MODEL	A (mm)	B (mm)	H min (mm)	H max (mm)
Z - WP.a	140	1300	550	750
Z - WP.b	240	1300	550	750
Z - WP.c	340	1800	750	1000
Z - WP.d	440	1800	750	1000

white ws separator

with single roller

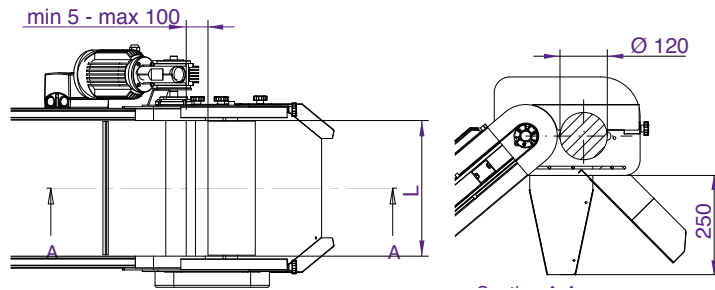

white wt separator

with spiral separator

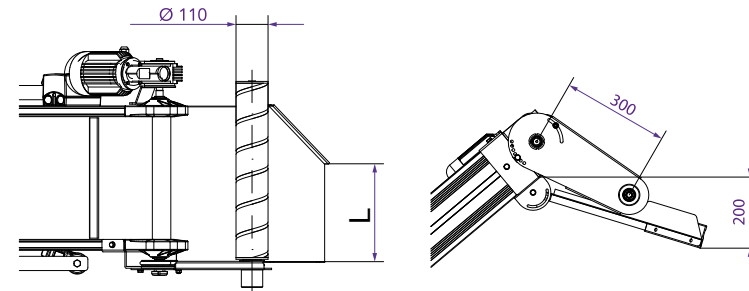

CHARACTERISTICS

- Single roller separator installed on CHECK or MATE conveyors
- The distance between conveyor belt and paddle separator can be adjusted according to the difference in dimensions and shape between sprues and good parts

WHITE WS		
MODEL	L (mm)	APPLICATION
WHITE WS.a	240	CHECK / MATE
WHITE WS.b	340	
WHITE WS.c	440	

CHARACTERISTICS

- Spiral separator installed on CHECK or MATE conveyors
- The distance between conveyor belt and paddle separator can be adjusted according to the difference in dimensions and shape between sprues and good parts

WHITE WT		
MODEL	L (mm)	APPLICATION
WHITE WT.a	175	CHECK / MATE
WHITE WT.b	275	
WHITE WT.c	375	

black br separator

rotary drum

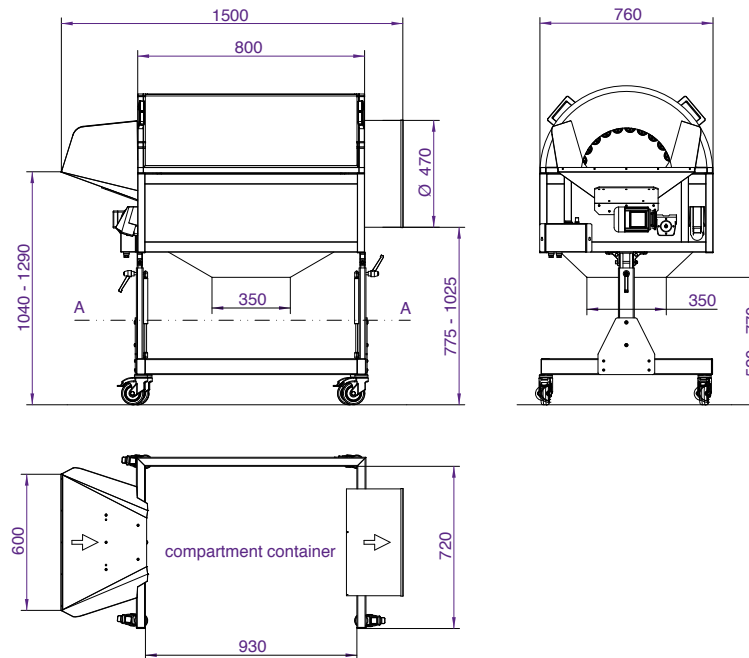

TECHNICAL FEATURES

- Separator with rotary drum consisting of 24 PVC rollers having 50 mm diameter and 800 mm length with adjustable distance between each other
- Drum separator complete with Inverter: adjustable speed range from min 4 rotations/minute, maximum 20 rotations/minute
- Motor connection voltage: 220V/50Hz, single-phase
- Separator standing on rotating wheels Ø 100 mm complete with brake
- Adjustable in height
- Input and output chutes made in stainless steel
- Optional: automatic rollers adjustment

ATTENTION! The standard inlet chute is suitable only when the loading conveyor is in line with separator. If the loading conveyor is placed orthogonally to the separator, we are at your disposal to offer an alternative special orthogonal chute

DIMENSIONAL FEATURES

- Diameter of the drum 470 mm
- Useful length of the drum 800 mm
- Loading height: minimum 1040 mm and maximum 1290 mm
- Frontal unloading height: minimum 775 mm and maximum 1025 mm
- Lower unloading height: minimum 520 mm and maximum 770 mm
- Overall length of the separator 1500 mm

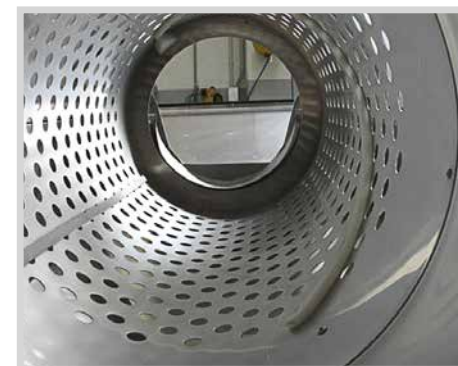
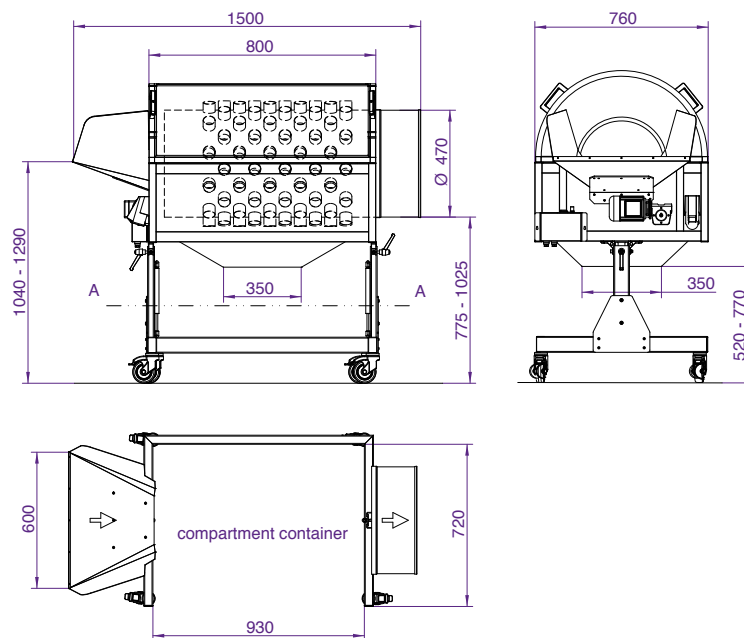

TECHNICAL FEATURES

- Separator with perforated rotary drum made in stainless steel
- Drum separator complete with Inverter: adjustable speed range from min 4 rotations/minute, maximum 20 rotations/minute
- Motor connection voltage: 220V/50Hz, single-phase
- Separator standing on rotating wheels \varnothing 100 mm complete with brake
- Adjustable in height
- Input and output chutes of the pieces made in stainless steel
- Optional: drum with holes + 255 tubes (internal \varnothing 32 mm x h 50 mm)

DIMENSIONAL FEATURES

- Diameter of the drum 470 mm
- Useful length of the drum 800 mm
- Loading height: minimum 1040 mm and maximum 1290 mm
- Frontal unloading height: minimum 775 mm and maximum 1025 mm
- Lower unloading height: minimum 520 mm and maximum 770 mm
- Overall length of the separator 1500 mm

ATTENTION! The standard inlet chute is suitable only when the loading conveyor is in line with separator. If the loading conveyor is placed orthogonally to the separator, we are at your disposal to offer an alternative special orthogonal chute

castle stair elevator

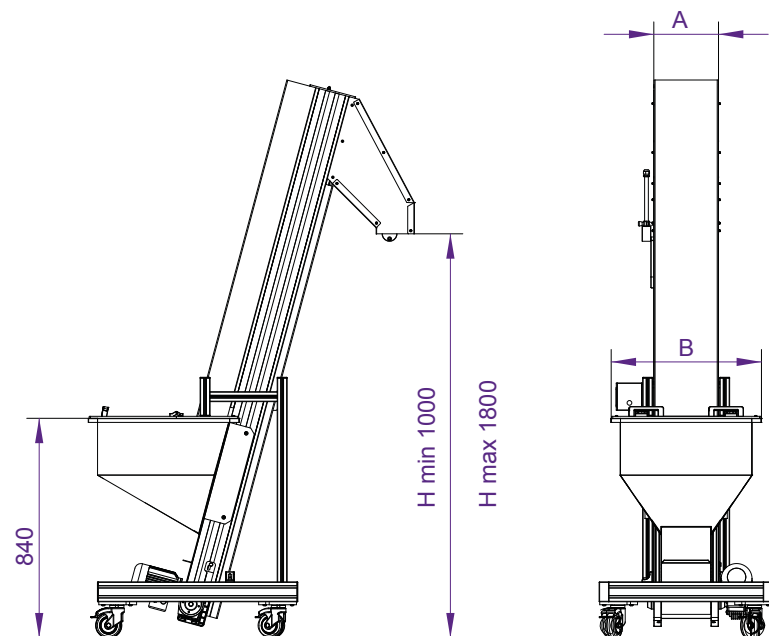

CHARACTERISTICS

- Suitable for the collection of products from a hopper and their elevation
- Appropriate for plastic cap closures transport
- As an option: FDA version to convey specific components

TECHNICAL FEATURES

- Structure made of aluminium anodised profile
- With side panels height 40 mm
- PU belt with slats h 30 pitch 150 mm, vulcanised belt joint. Temperature resistance from -10°C to + 90°C
- Elevator complete with loading hopper
- Slope canal of the elevator complete with polycarbonate covering
- Elevator mounted on anti-vibrating feet or wheels
- Transmission group composed of: three-phase motor, coupled to worm reduction unit with lubrication for life
- Fixed standard speed 12 m/min
- Equipped with Start/Stop motor cut-out
- Standard motor supply voltage 400V/50 Hz

STAIR 600 DIMENSIONS

DIMENSION	A (mm)	B (mm)	HOPPER CAPACITY	H min (mm)	H max (mm)
STAIR 600	200	600	80 lt	1000	1800

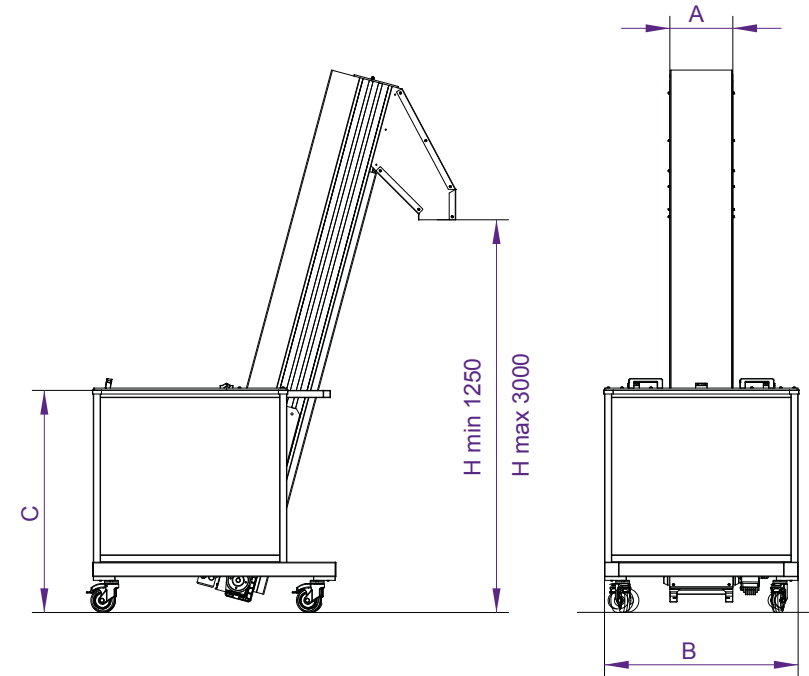

CHARACTERISTICS

- Suitable for the collection of products from a hopper and their elevation
- Appropriate for plastic cap closures transport
- As an option: FDA version to convey specific components

TECHNICAL FEATURES

- Structure made of aluminium anodised profile
- With side panels height 40 mm
- PU belt with slats h 30 pitch 150 mm, vulcanised belt joint. Temperature resistance from -10°C to + 90°C
- Elevator complete with loading hopper
- Slope canal of the elevator complete with polycarbonate covering
- Elevator mounted on anti-vibrating feet or wheels
- Transmission group composed of: three-phase motor, coupled to worm reduction unit with lubrication for life
- Fixed standard speed 12 m/min
- Equipped with Start/Stop motor cut-out
- Standard motor supply voltage 400V/50 Hz

STAIR 800 - 900 - 1000 DIMENSIONS						
DIMENSION	A (mm)	B (mm)	C (mm)	HOPPER CAPACITY	H min (mm)	H max (mm)
STAIR 800	200	800	930	185 lt	1250	3000
STAIR 900	300	800	930	185 lt	1250	3000
STAIR 1000	300	1000	1130	410 lt	1250	3000

for boxes

for bags

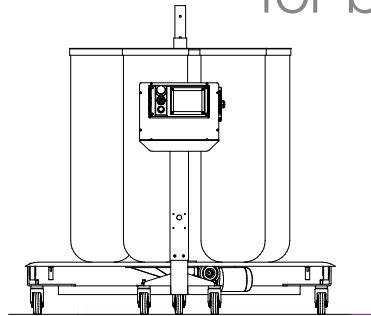
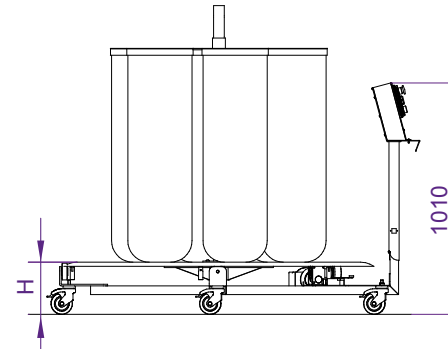
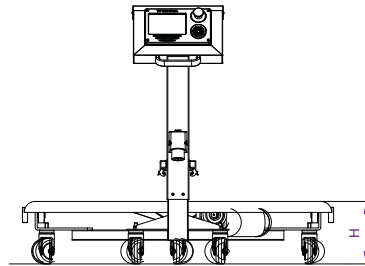
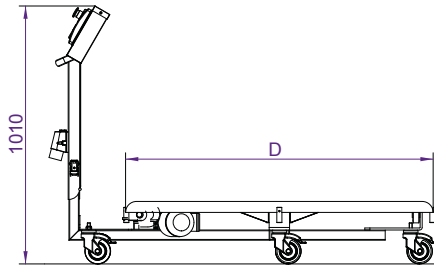

CHARACTERISTICS

- O-ROUND: a basic turntable to fill boxes/cartons or bags
- Disc structure made of stainless steel AISI 430 thickness 4 mm
- Possible to install some supporting brackets for boxes/cartons or a bag-holder frame supported by a central rod
- Turntable complete with control panel TV having the following functioning logic:
 - An external voltage-free normally open NO clean contact linked to the production cycle of the IMM is memorized by the relative pulse counter. Every enabling signal on the input corresponds to a moulding phase and every moulding phase corresponds to a certain quantity of product. The number of enabling signals required to fill the container is selected on the control panel. Once the selected number of enabling signals has arrived, the pulse counter stops the loading conveyor, starts counting the enabling signals from zero again, turns the table to the next loading station and starts the loading conveyor once more. Any stamping phases that may have occurred as the machine switched from one loading station to the next will be memorized by the pulse counter. The control panel is complete of a signal that can be used to stop the loading conveyor during the turntable's rotation during the turntable's rotation

TECHNICAL FEATURES

- Possible diameter Ø 1200 mm or Ø 1450 mm
- Height of the disc from the floor = ~250 mm
- Capacity of the turntable 120 kg - 140 kg
- Speed of the turntable 1,7 - 2,2 tours per minute
- Standard motor supply voltage 400V/50 Hz

O-ROUND DIMENSIONS

DIMENSION	D (mm)	H (mm)	CAPACITY	ROTATION SPEED
O-ROUND.a	1200	250	120 kg	2,2 rpm
O-ROUND.b	1450	250	140 kg	1,7 rpm

on two levels (for boxes)

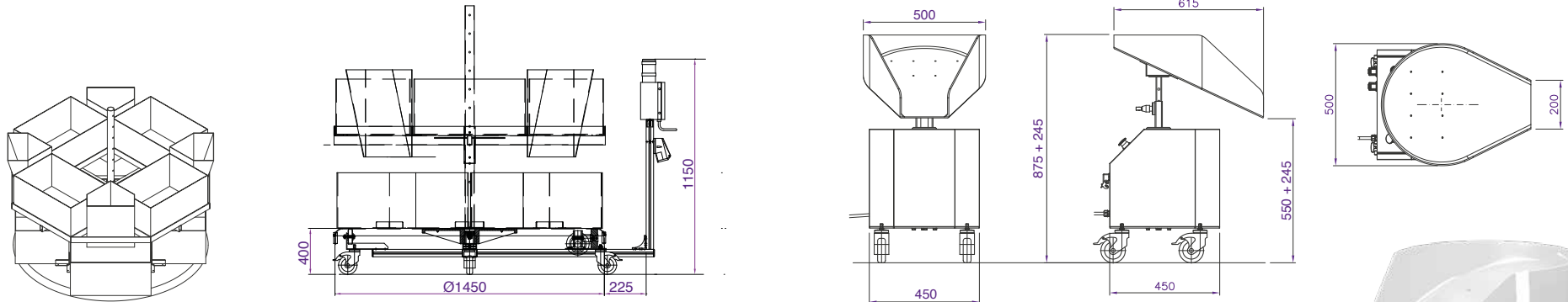

TECHNICAL SPECIFICATIONS

- Application to optimize the number of filled containers and increase the IMM autonomy
- Turntable for filling containers placed on two levels
- Filling logic: with IMM cycles count or with setting of filling time
- Diameter Ø 1450 mm
- Optional: polycarbonate O-ROUND protection

SPECIAL DOUBLE O-ROUND FOR 4+4 CONTAINERS

MODEL	D (mm)
DOUBLE O-ROUND	1450

CHARACTERISTICS

- Dispenser to distribute the product coming from a conveyor into different containers
- Dispenser with 360° rotating chute: it could be positioned near the press at any point along the storage path (longitudinal, lateral and perpendicular)
- Functioning logic: using signal from the IMM or programming the filling time

TECHNICAL FEATURES

- Max capacity: 2 kg for a single product
- Motor power 0.06 kw
- Standard motor supply voltage 400V/50 Hz
- Weight 40 kg
- Material of chute: ABS
- Options: unloading chute made of INOX A304 or unloading chute made of INOX A304 with deviators

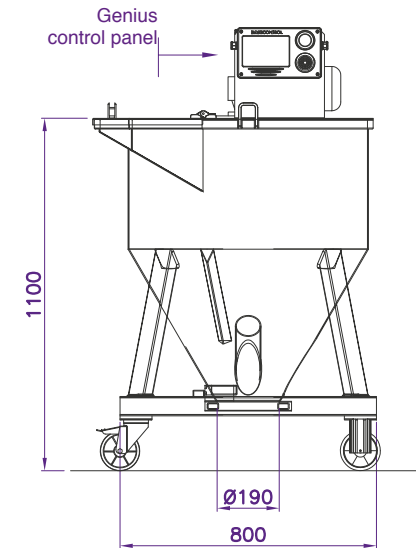
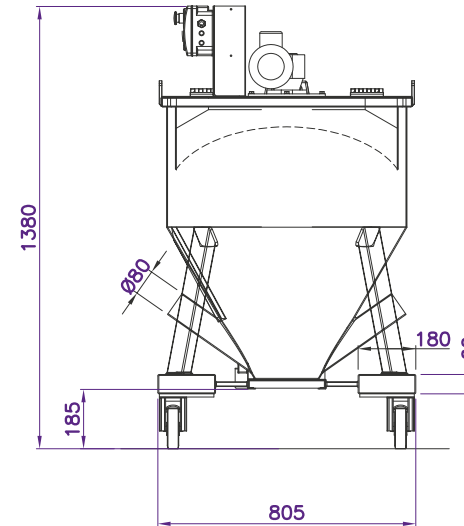
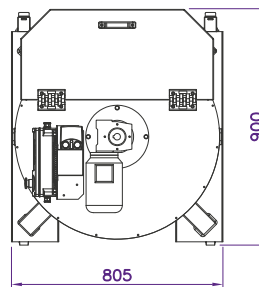

CHARACTERISTICS

- This mixer called BLEND is suitable for mixing small quantities of product
- It is therefore suitable when the product batches are not very large
- The mixing principle is the following: on request, the screw is enclosed in a tube and the material is fed from the top. The mixed product is usually taken by means of a suction nozzle and fed into one of the two cone-shaped side tubes of the container. The gate valve for rapid unloading and/or cleaning inside the mixer hopper and the hopper lid are protected by micro switches

TECHNICAL FEATURES

- Mixer realized in varnished FE (as an option in INOX 304)
- Capacity of the mixer 240 litres
- Mixer screw rotation speed 200 per minute
- Power of the transmission group 0,75 kW
- Mixer standing on rotating wheels (two with brake)
- Mixer complete with Genius Control Panel having the following functions:
 - Manual: march/stop through plungers
 - Automatic: functioning for the established time of run
 - Safety: circuit to stop the mixer's functioning if the cap is raised or to let the mixer run with raised cap
- Standard motor supply voltage 400V/50 Hz

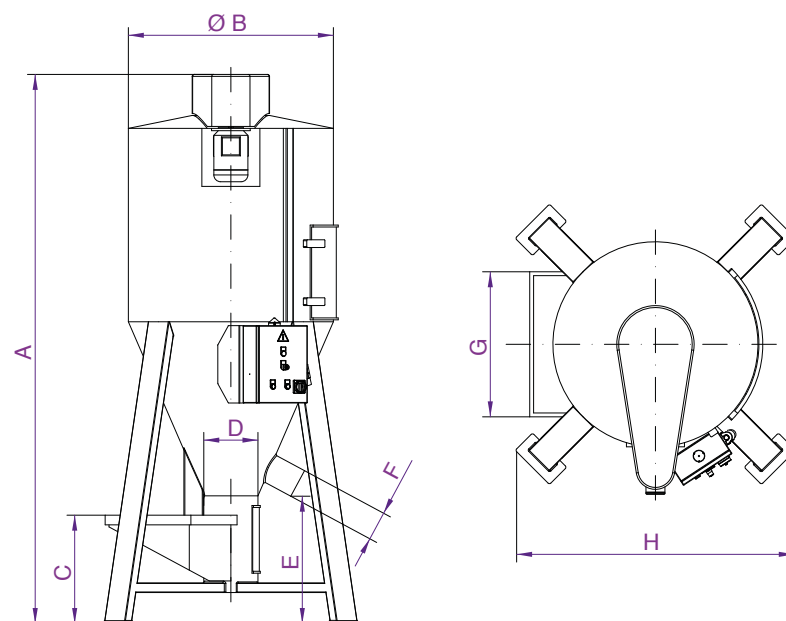

CHARACTERISTICS

- BIG BLEND mixer is a solution that has always been used for mixing plastic material granules. It consists of an outer frame made of painted sheet metal and an internal screw (optional in BIG BLEND 2/3 and 4) inside a tube for mixing the contents. The material to be mixed is fed into the loading hopper, the screw receives it from below and carries it upwards releasing it on top, spreading it inside the mixer body with a radius of 360°. After about 15/20 minutes, the material is perfectly mixed
- The BIG BLEND includes the control panel, with the Start and Stop functions and time settings
- The inspection hatches for the screw conveyor and mixer are protected by safety microswitches

TECHNICAL FEATURES

- The mixed material outlet tube is complete with gate valve
- Screw is enclosed in a tube along its entire length
- When the inspection hatch is open, big blend will not run
- Both doors have a pair of safety latches and microswitches for protection
- The power cable and cables of the micro switches are protected in a cable duct

BIG BLEND DIMENSIONS

DIMENSION	CAPACITY	A (mm)	B (mm)	C (mm)	D (mm)	E (mm)	F (mm)	G (mm)	H (mm)
BIG BLEND 2/3	500 lt	2550	850	600	200	800	150	850	1150
BIG BLEND 4	1000 lt	3050	1060	650	280	800	200	750	1250
BIG BLEND 5	1800 lt	3200	1400	700	320	800	230	950	1400
BIG BLEND 6	2500 lt	3500	1500	700	320	800	230	950	1450
BIG BLEND 7	3500 lt	3900	1600	700	320	800	230	950	1500
BIG BLEND 8	5000 lt	4200	1900	750	320	800	230	1000	1800
BIG BLEND 9	8000 lt	4600	2350	750	320	800	230	1000	1950
BIG BLEND 10	10000 lt	5100	2350	750	320	800	230	1000	1950
BIG BLEND 11	14000 lt	5600	2450	750	320	800	230	1100	2150

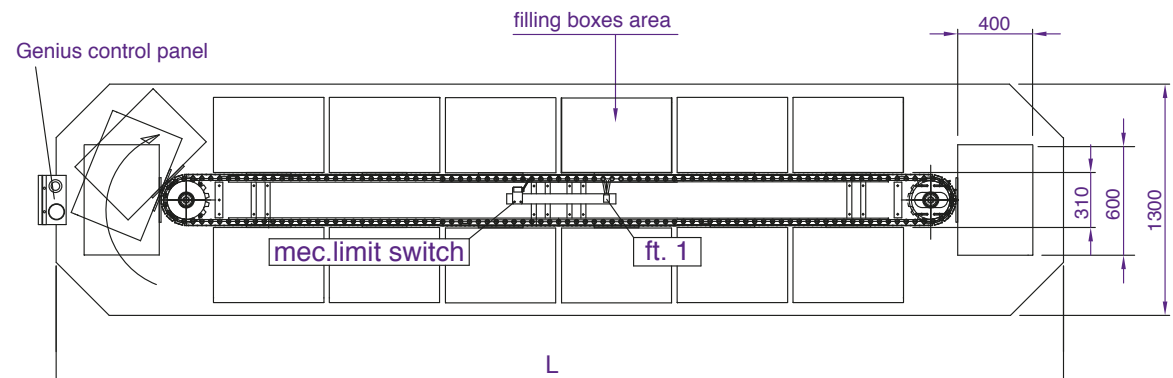

CHARACTERISTICS

- Horizontal "Dolly Carousel" involves counting the IMM moulded items to be stored in each container
- On reaching the present quantity, the "Dolly Carousel" rotates the containers so that an empty one is placed in the loading area

TECHNICAL SPECIFICATIONS

- Carousel storage system to fill cartons with standard dimensions 400x600 mm
- The cartons are placed on mobile platforms, all of the same predetermined size, fixed on a central chain
- The boxes can be filled by means of a robotic arm or conveyor belt
- The cartons are filled one at a time, so that at each box change (next empty carton replacing the one just filled in the loading position) corresponds to a platform displacement
- The correct positioning of the next empty box is ensured by a blocking device
- Carousel complete with Genius Control panel:
 - The logic includes counting of the moulding cycles to be stored within each container. Once the set amount is reached, the carousel rotates the containers until the next empty container is placed in the loading position
- Standard motor supply voltage 400V/50 Hz

DOLLY CAROUSEL		
MODEL	NO. PLATFORMS/BOXES (400x600 mm)	LENGTH L (mm)
DOLLY 8	8	3700
DOLLY 10	10	4350
DOLLY 12	12	5000
DOLLY 14	14	5650
DOLLY 16	16	6300
DOLLY 18	18	6950
DOLLY 20	20	7600





roma

Roma srl - Via Roma, 188/B
36070 CASTELGOMBERTO (VI)
ph +39 0445 940 248
sales@romatomove.com
www.romatomove.com

Roma 2020. All rights reserved.

Unless otherwise indicated, all materials on these pages are copyrighted by Roma srl. All rights reserved. No part of these pages, either text or image may be used without prior written permission.
NOTE: Images shown are indicative only. Color or Model may differ from the picture shown (Features will remain same or more)



Roma srl - Via Roma, 188/B
36070 CASTELGOMBERTO (VI)
ph +39 0445 940 248
sales@romatomove.com
www.romatomove.com